

2127.3  
1468.7  
808.6

B37

to allow for temperature

Note: distance actually measured —  
63+44<sup>PS</sup> 2127.0 " " Center line of Quincy ave  
70+00<sup>24</sup> 1468.5 " " " " " " 30<sup>th</sup> St  
76+63<sup>24</sup> 808.5 Set Hub for South line of 29<sup>th</sup> St

End at (Mag<sup>t</sup> bearing = S 16 1/2 E)  
South of S line 26<sup>th</sup> St double curbed  
P.S. on Hub Center of Quincy &  
End over mt #16 28<sup>th</sup> & Quincy  
to be 771.00

A. F. PARKER.

Monroe Ave found measurement  
Hub previously set center 28<sup>th</sup> &  
28<sup>th</sup> & Quincy met to intersection  
distance measured from mt #16  
End 22<sup>th</sup> street = 771.11

First chained bet mts Quincy & Monroe  
Location Block 7 Plot C

Monday Ave, Nov 11<sup>th</sup> 1889

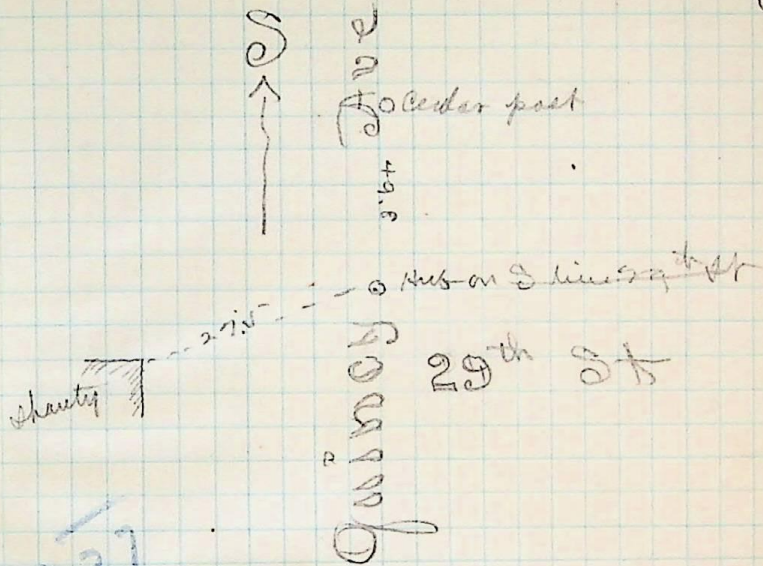

A. F. PARKER.

